



# Penn Manor High School Schematic Design Discussion

Public Update on Schematic Design

April 25, 2017



Crabtree, Rohrbaugh & Associates, Architects

### Guiding Principles:

- Community – PMHS should serve as the center of the community, an active hub of educational, social, physical and entertainment activity.
- Transparency – The learning environment should result from a planning / design process involving all stakeholders.
- Focused learning – The learning environment should enhance teaching and learning by providing hands-on, collaborative and real-world experiences, accommodating the needs of ALL students.
- Flexibility - The learning environment should allow for Flexibility & Adaptability to meet changing needs.
- Safety & Security - The learning environment should provide for Health, Safety & Security.
- Technology – Technology should be ubiquitous and used to create opportunities for students for learning, networking and collaboration.
- School Environment – The school environment should be welcoming, comfortable and appealing, instilling a sense of pride in the students, staff & community.

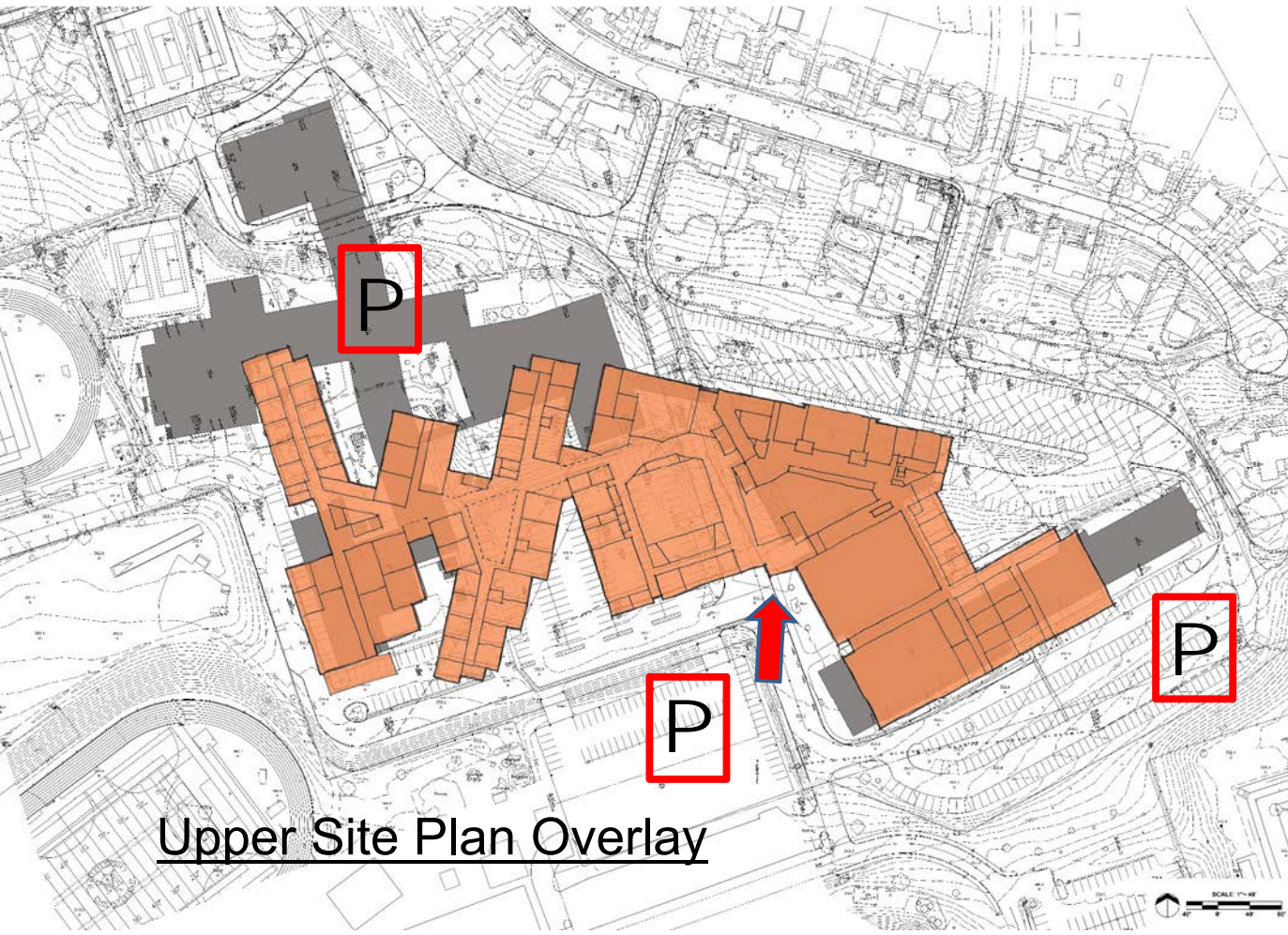

Upper Site Plan Overlay

- Proposed Building Footprint
- P Parking
- Existing Building Footprint







Massing Model Overlay

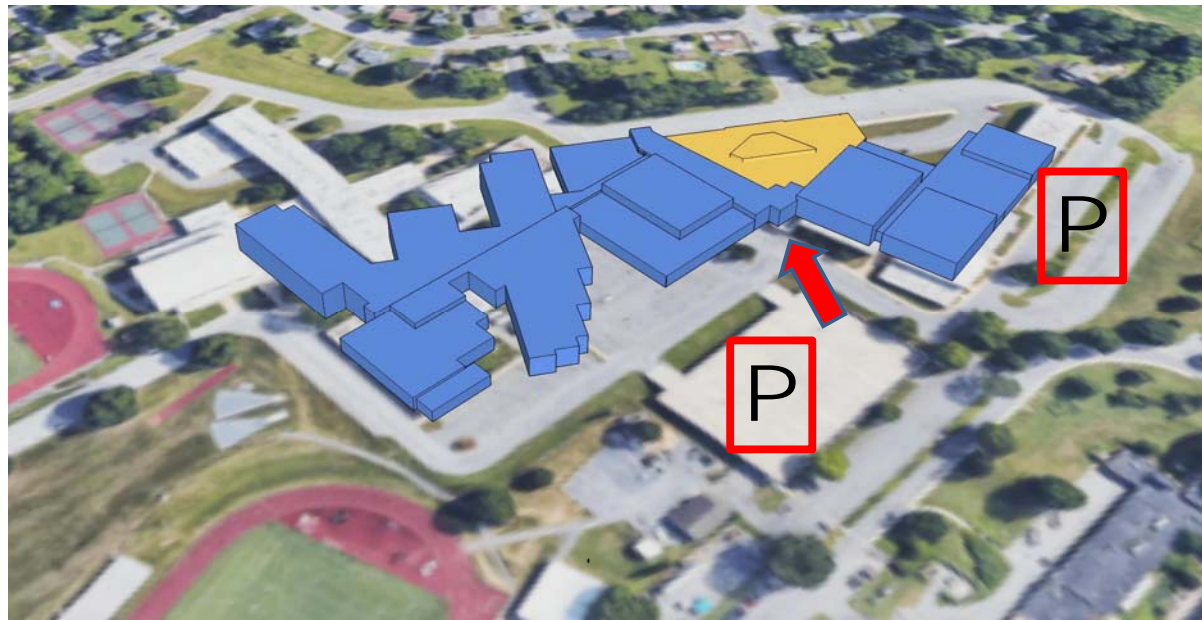

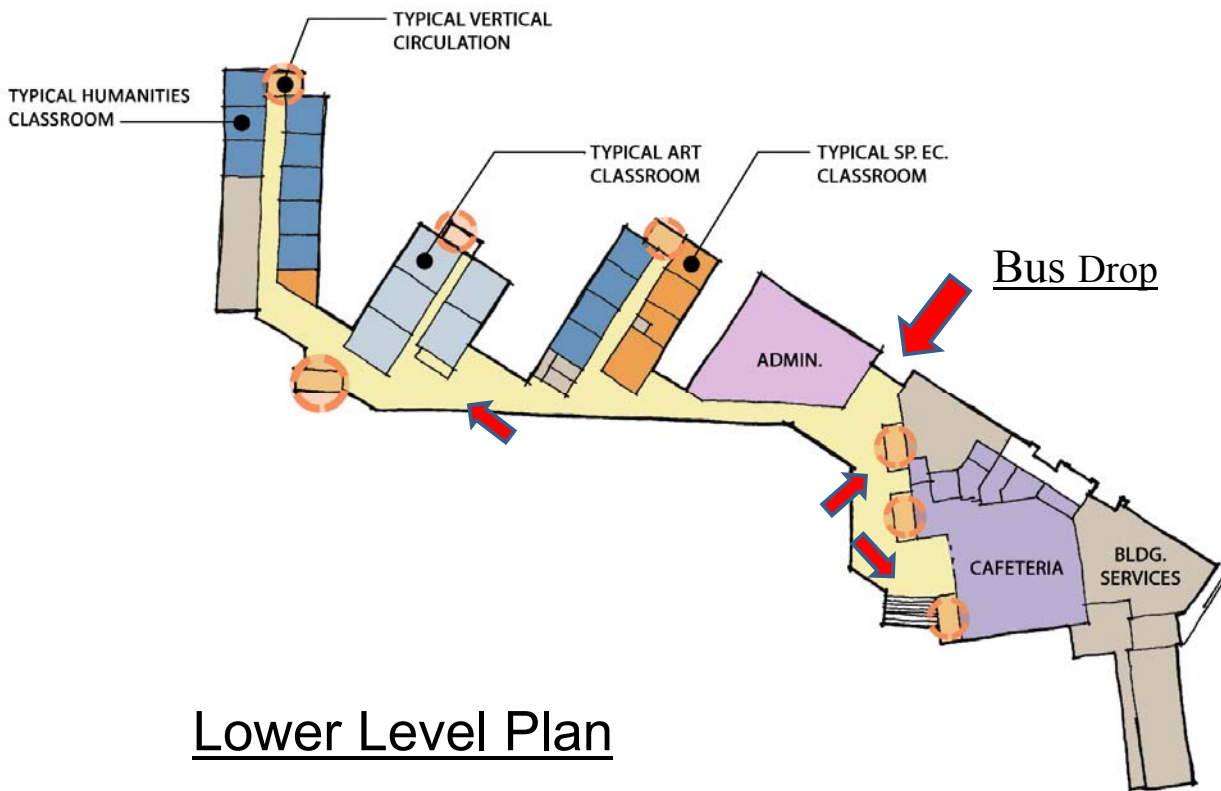

- Cafeteria/Kitchen expanded
- Art Core
- Administration
- Humanities suite
- Special Education
- Building support/systems expanded



Collision Spaces





Natural Daylight



Main Level Plan

- Athletics
- LGI/Black Box Theater
- Media Center/Technology
- Performance Arts core
- Humanities wings
- Special Education
- STE(A)M Core
- AG/Technology Labs





Transparent Spaces



Outdoor Learning Spaces





- Collision Spaces
- Natural Daylight
- Wayfinding



Main Level Plan

- Athletics
- LGI/Black Box Theater
- Media Center/Technology
- Performance Arts core
- Humanities wings
- Special Education
- STE(A)M Core
- AG/Technology Labs





'Maker' Spaces





## Transparency and Flexibility

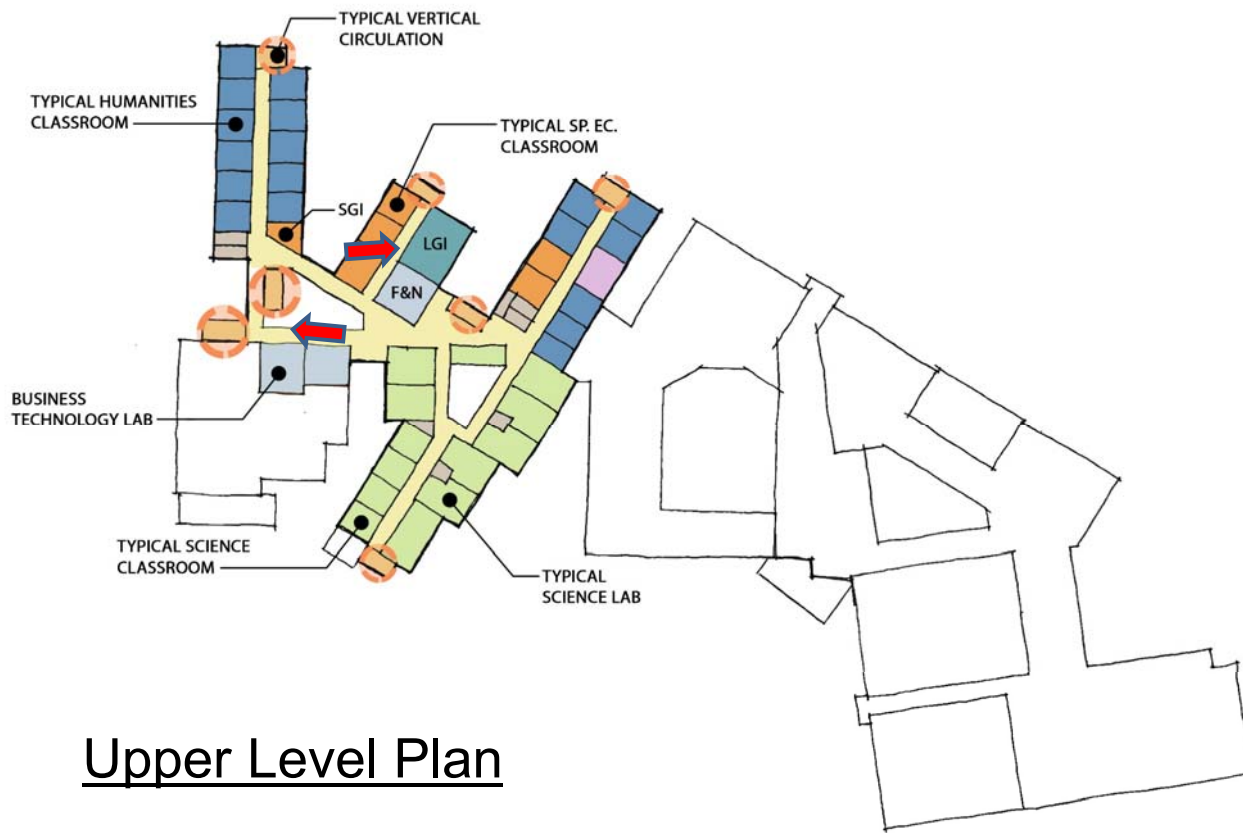

- Humanities Suite
- Special Education
- STEM Core
- Humanities LGI

Upper Level Plan





Vertical Circulation



Teaching Niches

# Next Meetings

- ✓ Ongoing Leadership Team Meetings
- ✓ Design and Engineering Coordination
- ✓ Faculty Meetings in Fall
- ✓ Pre-Construction Phasing Meetings





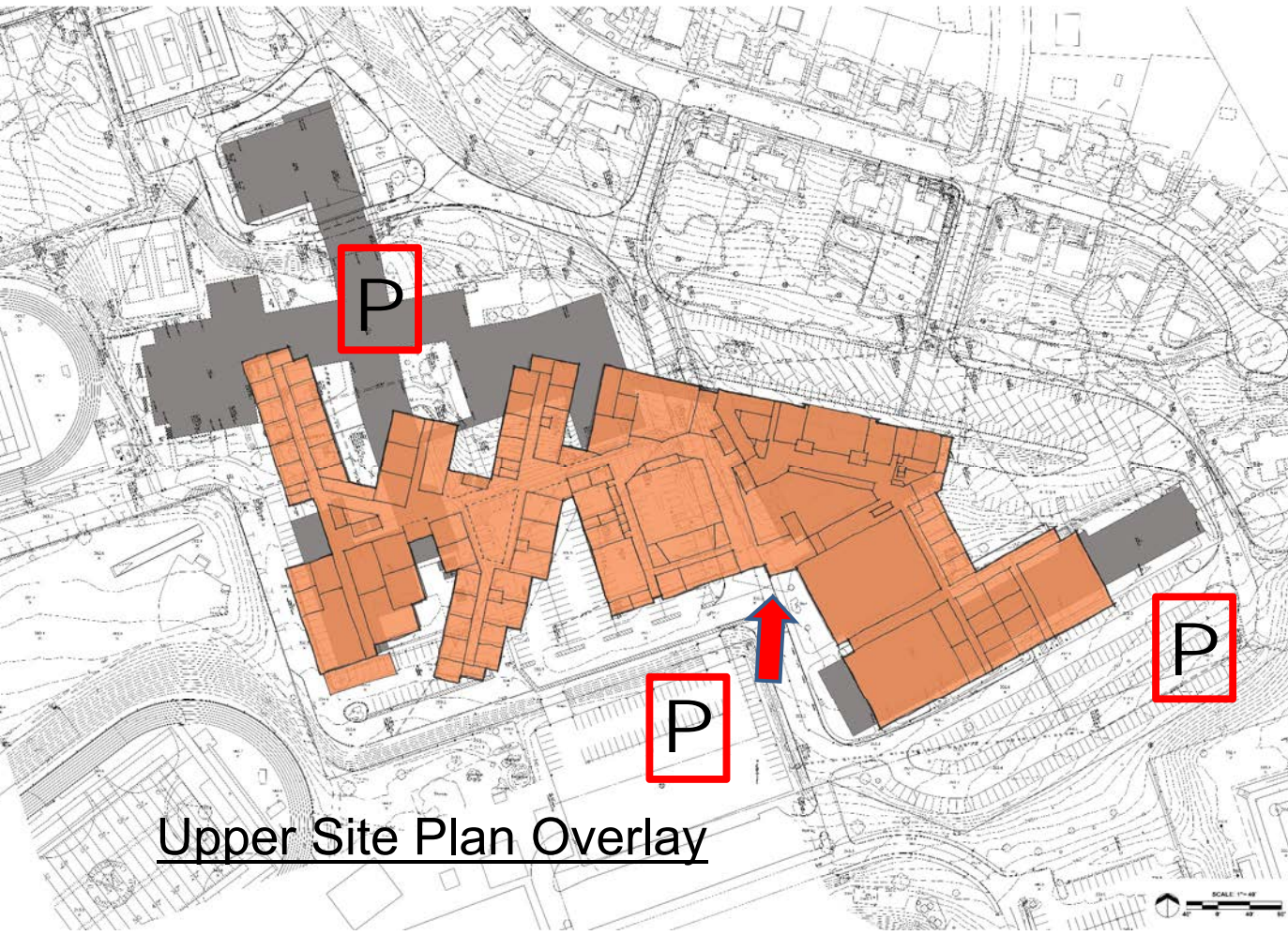

Upper Site Plan Overlay

- Proposed Building Footprint
- P Parking
- Existing Building Footprint





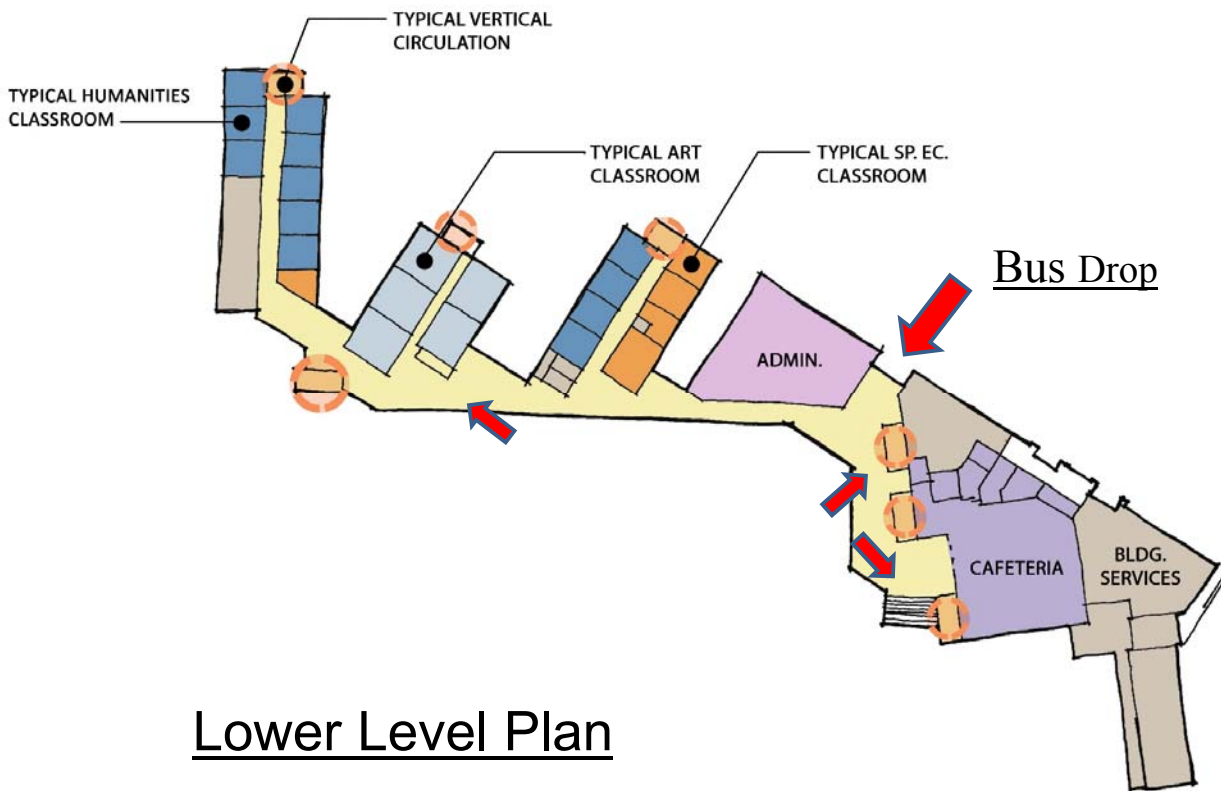

- Cafeteria/Kitchen expanded
- Art Core
- Administration
- Humanities suite
- Special Education
- Building support/systems expanded



Main Level Plan

- Athletics
- LGI/Food Service
- Media Center/Technology
- Performance Arts core
- Humanities wings
- Special Education
- STEM Core
- AG/Technology Labs



- Humanities wings
- Special Education
- STEM Core
- Humanities LGI





Collision Spaces

# Penn Manor High School Master Plan



## OPTION: Site Plan

Renovations & Additions to the Existing Building – Replace majority of the building



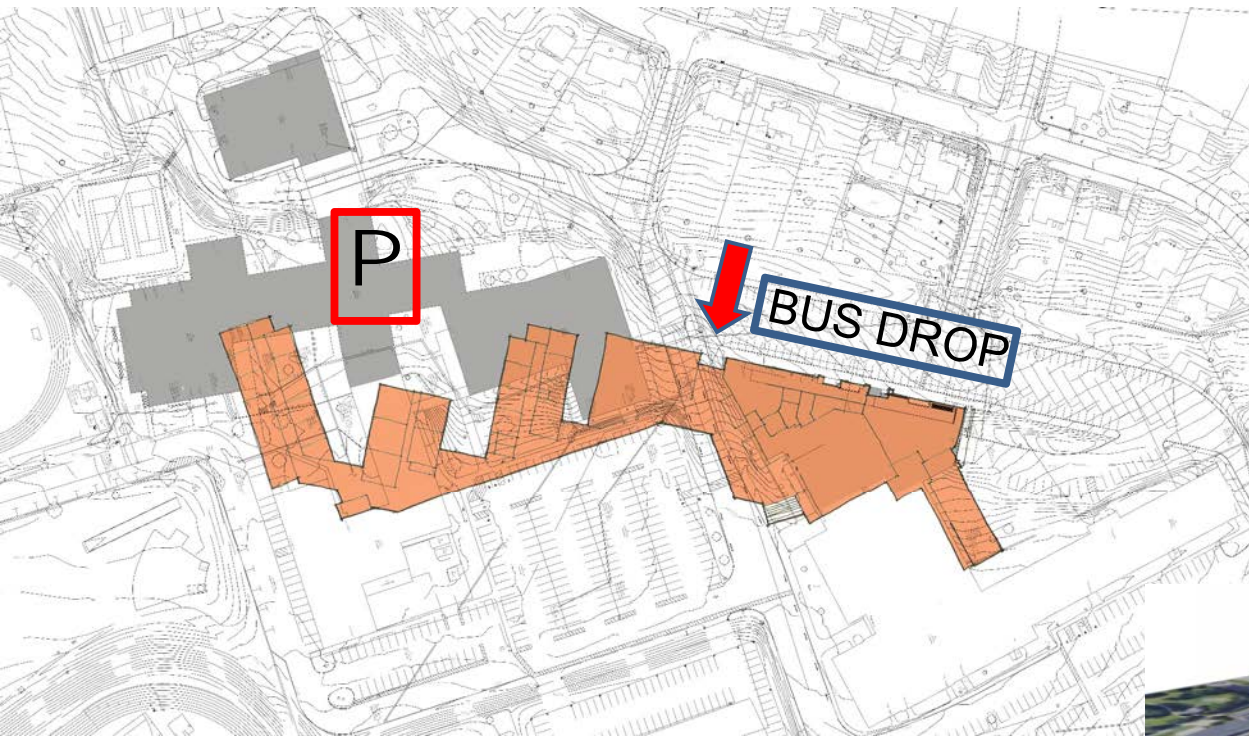

- Proposed Building Footprint
- P Parking
- Existing Building Footprint

Lower Site Plan Overlay

